

# Arnolds | Keys



## 7 Upcher Crescent, Off Holway Road, Sheringham, Norfolk, £975 Per Calendar Month

- Modern Ground Floor Purpose Built Flat
- Gas Central Heating & UPVC Double Glazing
- 1 Double Bedroom
- EPC Rating B
- Open Plan Living / Dining / Fitted Kitchen
- Private Enclosed South Facing Patio Garden
- Bathroom With Over Bath Shower
- Kitchen With Appliances
- Allocated Off Road Parking Space
- Delightful & Popular Recent Development

25 King Street, Norwich, Norfolk, NR1 1PD  
01603 216812

[lettings@arnoldskeys.com](mailto:lettings@arnoldskeys.com)  
[www.arnoldskeys.com](http://www.arnoldskeys.com)

## GROUND FLOOR

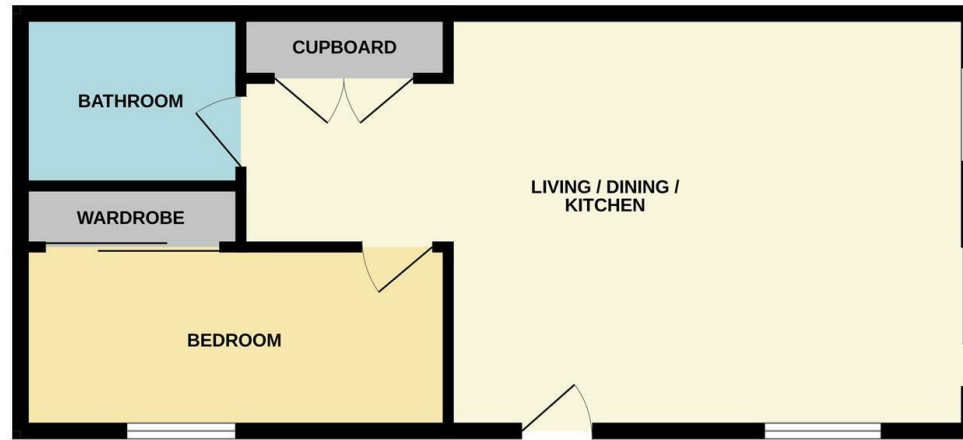

Whilst every attempt has been made to ensure the accuracy of the floorplan contained here, measurements of doors, windows, rooms and any other items are approximate and no responsibility is taken for any error, omission or mis-statement. This plan is for illustrative purposes only and should be used as such by any prospective purchaser. The services, systems and appliances shown have not been tested and no guarantee as to their operability or efficiency can be given.  
Made with Metropix ©2025

## Directions

## Viewings

Viewings by arrangement only. Call 01603 216812 to make an appointment.

## Council Tax Band

B

## EPC Rating:

B

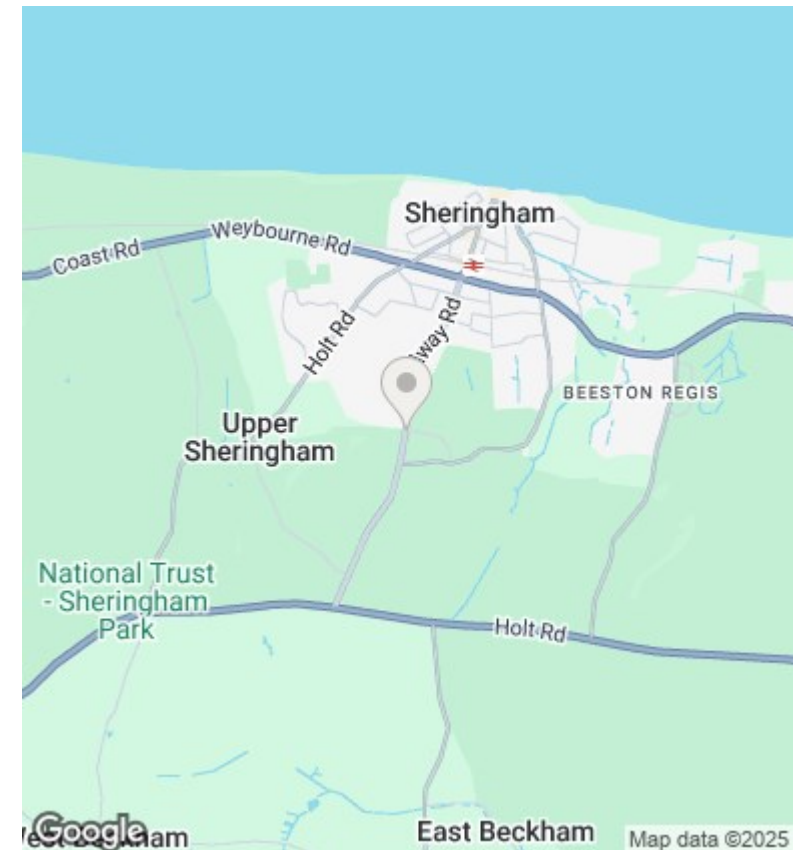

Energy Efficiency Rating		
	Current	Potential
Very energy efficient - lower running costs		
(92 plus) <b>A</b>		
(81-91) <b>B</b>	83	83
(69-80) <b>C</b>		
(55-68) <b>D</b>		
(39-54) <b>E</b>		
(21-38) <b>F</b>		
(1-20) <b>G</b>		
Not energy efficient - higher running costs		
England & Wales	EU Directive 2002/91/EC	